

PLAN SHEETING PROPERTY
 SAID TO BELONG TO
 (A) BASHIRU SALAU BANI ASUNMOGEO/SALAMI CHIEFTANCY FAMILY
 (B) THIRD MAINLAND COURT
 LOCATED ON BASHIRU BANI ASUNMOGEO SALAMI CHIEFTANCY FAMILY LAND, OWOORSHOKI
 KOSOFE LOCAL GOVT/AREA
 LAGOS STATE
 ORIGIN - UTM (ZONE 31)
 SCALE - 1:10000

AREA (A) = 52.888HECTARES (130.439ACRES)
 AREA (B) = 98.415HECTARES (227.786ACRES)

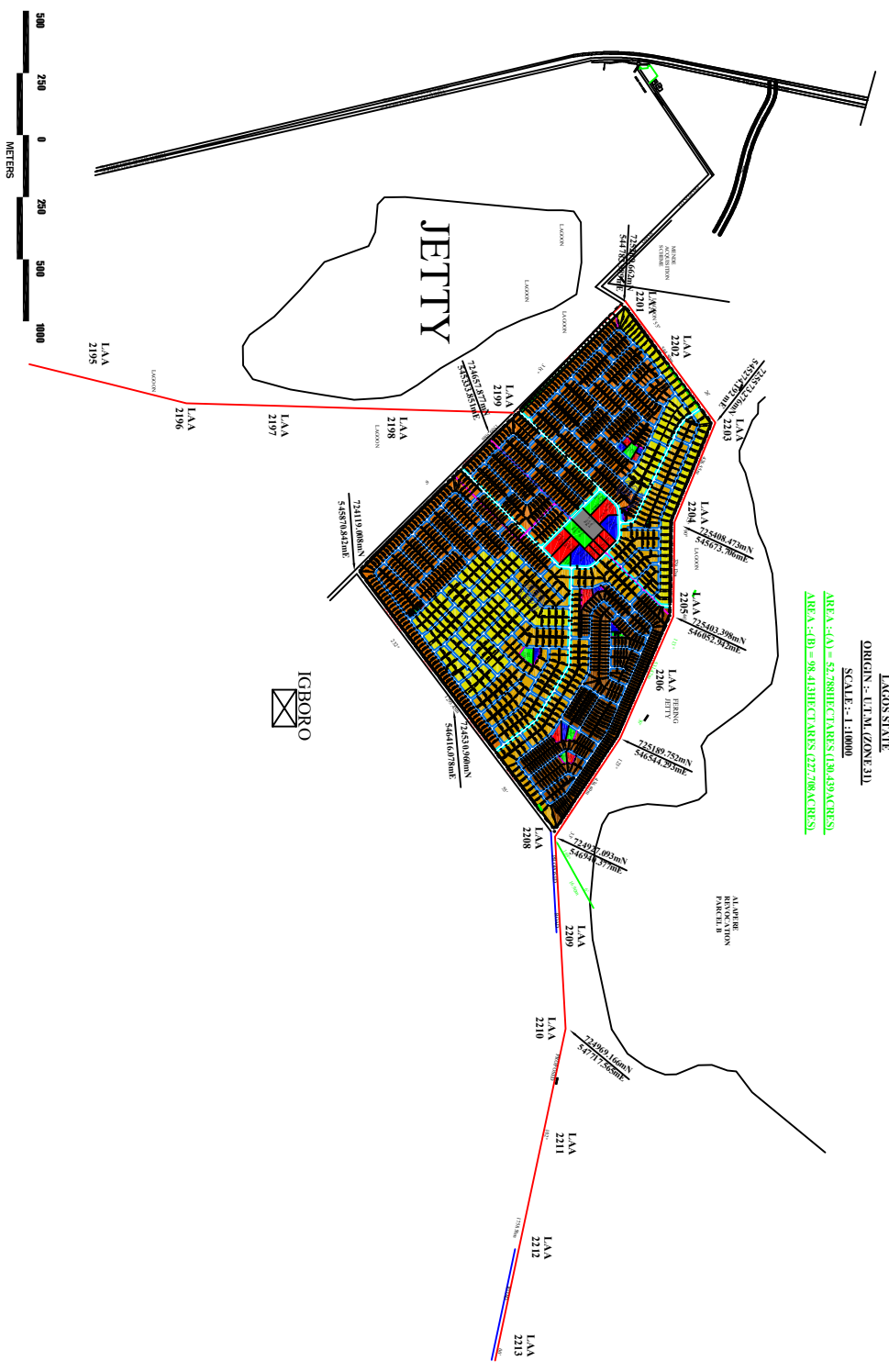

LEGEND

PROJECT:		TITLE:		FIGURE:		UNLESS OTHER-WISE SPECIFY:		CLIENT:	
PROPOSED RESIDENTIAL LAYOUT		LAYOUT PLAN		18		DIMENSIONS IN: MILLIMETERS <input type="checkbox"/> CENTIMETERS <input type="checkbox"/> METERS <input checked="" type="checkbox"/> INCHES <input type="checkbox"/> FEET <input type="checkbox"/> OTHERS <input type="checkbox"/>			
SITE:		SCALE:						CONSULTANTS:	
(A) BASHIRU BANI ASUNMOGEO SALAMI CHIEFTANCY FAMILY		LINEAR SCALE						[Redacted]	
(B) THIRD MAINLAND COURT		DATE:						[Redacted]	
		JULY 2017							



IGBOBO